

2005 Flow Control Innovation Award Winner

Promass Transmitter Features



Promass 83

- » Push-button operation for easy programming
- » Quick setup for fast and easy commissioning
- » Simultaneously record several process variables for various process conditions during measuring operation
- » Touch control operation allows programming without opening electronics
- » 4-line backlit display
- » Advanced diagnostics, batching and concentration measurement
- » IP 67 powder-coated die-cast aluminum field housing



We put you first.
And keep you ahead.



We put you first.
And keep you ahead.

FMC Technologies
Measurement Solutions, Inc.
500 North Sam Houston Parkway West,
Suite 100
Houston, Texas 77067 USA
P: +1 281.260.2190

USA Operation
1602 Wagner Avenue
Erie, Pennsylvania 16510 USA
P: +1 814.898.5000

www.fmctechnologies.com/measurementsolutions

Proline® Promass E Coriolis Flowmeter

Product Guide for
Petroleum and
Production Metering



Measurement Solutions

Proline Promass E Coriolis Meters

Leading the field with Coriolis innovations

- » Perfected straight dual tube design to make true "Fit-and-Forget" meters, eliminating the need for expensive pipe supports and long lengths of straight pipe runs in your installation
- » Solved the problem of zero point drift through highly sophisticated welding and manufacturing techniques that ensure highest accuracy in welding tolerances and lowest impact on zero point stability
- » Developed DSP (Digital Signal Processing) technology for Promass 83 transmitter to improve the signal-to-noise ratio and ensure optimum speed and accuracy – it is the fastest on the market

Benefits of Coriolis Flowmeters from FMC Technologies

- » Self-draining designs eliminate problems with clogging
- » High-speed measuring with 20 ms response time
- » Increased immunity to common pipeline noise
- » Immunity to pipeline loading stress
- » Routine re-zeroing of the meters is not necessary
- » No supports or braces are needed for installation
- » Temperature changes do not affect zero point stability

Sensors best price, density accuracy, and stability

- » Highest density accuracy
- » Compact, dual-tube design
- » Rupture disk in the sensor housing (optional)
- » Universal sensor, handles most applications – sizes 3/8" to 3"
- » Sensor material: stainless steel 904L/316L
- » Maximum fluid temperatures up to 284°F

SIZE RANGE ¹	lb/min	BPH	GPM
3/8"	0 to 73.5	13	9
1/2"	0 to 238	41	29
1"	0 to 660	113	79
1-1/2"	0 to 1,650	283	198
2"	0 to 2,570	441	309
3"	0 to 6,600	1,132	794

ACCURACY	
Liquid	
Flow Accuracy	+/- 0.15% of rate
Linearity	5% to 100% of max flow
Repeatability	+/- 0.075% in 5 runs *
Gas	
Mass of Flow Rate	+/- .75%
Density Accuracy	
Field/Reference	± 0.0005 g/cc
Special Cal.	± 0.001 g/cc
Standard Cal.	± 0.02 g/cc

* Per API Chapter 5.6 Table 1

FEATURES	
Tube Materials	904L
Process Temperature Range	-40 to 284°F
Max. Pressure Rating	1,200 psi
Remote Version	Yes

¹Flow rates based on process water

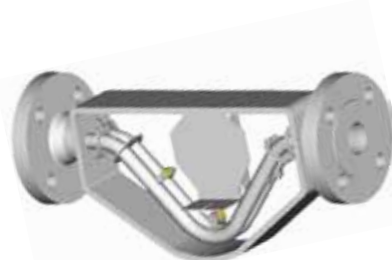

Transmitters most economical, multi-purpose, and highly sophisticated

Features
4-Line Backlit Display
Programming
HART
FieldTool
Touch Control
Housing
Compact aluminum
Compact stainless steel
Remote aluminum mount
65 ft. Maximum Remote Distance
Outputs¹
11 Fixed modules
8 Flexible modules
4 I/O combinations
Profibus-PA/DP
FOUNDATION Fieldbus
Modbus
Measured Variables
Mass flow
Volumetric flow
Density
Temperature
3 Totalizers
Sensor Memory Chip (S-Dat)
Transmitter Memory Chip (T-Dat)
Special Functions (F-Chip)
Advanced diagnostics
Concentration measurement
Batching
Quick Setup
Hazardous Area Approvals
XP; FM Cl. I Div. 1
Power Supply
85-260 VAC
20-55 VAC/16-62 VDC

¹Max number of:

Current outputs	3
Frequency outputs	2
Status/relay outputs	2
Status inputs	1